

Foshan Vanco Building Materials Co., Limited
www.vancopanel.com

Aluminum Composite Panel
Marble Roll Coated Aluminum Coil
Wooden Roll Coated Aluminum Coil



Company Profile

Established in 2006, Foshan Vanco Building Materials Co., Limited is a professional manufacturer and exporter for building materials, such as aluminum composite panel, aluminum composite ceiling, aluminum panel, aluminum ceiling ect. We devote ourselves to project designing, new technique developing and building up mutually-beneficial partnership. Located in Foshan city Guangdong province, we are easily accessed via convenient transportation. All of our export products comply with international quality standards and greatly appreciated in a variety of different markets throughout the world.

We have over 7 years of exporting management experience, we help our customers to find preferable products with reasonable price.

If you are interested in any of our products or would like to discuss a custom order, please feel free to contact us. We are looking forward to establishing successful business relationships with new clients around the world in the near future.

Aluminum Composite Panel

Aluminum Composite Panel (ACP) is made up of three layers, with two layers of aluminum skin on the top and bottom, and one layer of anti-toxic polyethylene material in the middle. Also, both of skin surfaces need to be pre-painted with special paint material like PVDF or PE resin under a specific temperature condition.

Product Structure

Alcadex ACP

Alcadex ACP is composed of LDPE and non-combustible mineral core which sandwiched by two aluminum foils. It is a versatile material for lots of applications.

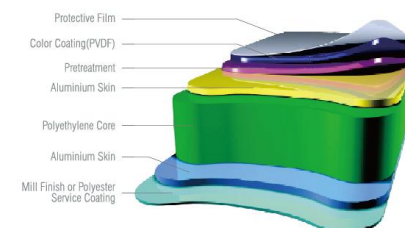

Alcadex FR

With more awareness for fire resistant materials around the world, we developed and introduced Alcadex FR material, which is fire safe for various architecture application.

Both Alcadex and Alcadex FR come in various attractive finishes such as solid colors, metallic colors, stone/wood finishes, anodized finishes and special customized designs.

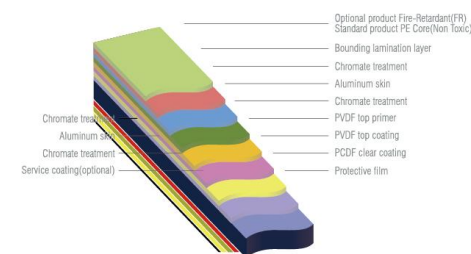

Specification

◆ Aluminum skin thickness:

0.50x0.50mm, 0.40x0.40mm, 0.30x0.30mm, 0.21x0.21mm, 0.15x0.15mm; 0.12mmx0.12mm

◆ Width:

1000mm, 1220mm, 1250mm, 1350mm, 1500mm, 1550mm, 1570mm, 1800mm, 2000mm(Maximum);

◆ Length:

depending on customers' offers; 6000mm(Maximum)

◆ Panel thickness:

1mm, 2mm, 3mm, 4mm, 5mm, 6mm, 8mm, 10mm

Scopes Of Application

- ◆ Constructional exterior curtain walls;
- ◆ Decorative renovation for storey-added old buildings;
- ◆ Indoors decoration for interior walls, ceilings, bathrooms, kitchens and balconies;
- ◆ Advertisement board, display platforms and signboards;
- ◆ Wallboard and ceilings for tunnels;
- ◆ Raw materials in industrial purpose;
- ◆ Materials used for vehicle and boat.

Loading Details

Panel size	Panel thickness	20'GP Loading Quantity			40'GP Loading Quantity		
	Alu-thickness	3mm	4mm	5mm	3mm	4mm	5mm
1220*2440mm	0.25+0.25mm	4587	3655	3038	6107	4873	4050
1220*2440mm	0.30+0.30mm	4380	3523	2946	5839	4697	3928
1220*2440mm	0.35+0.35mm	4190	3400	2859	5588	4533	3813
1220*2440mm	0.40+0.40mm	4018	3285	2778	5357	4380	3704
1220*2440mm	0.45+0.45mm	3859	3177	2700	5145	4237	3600
1220*2440mm	0.50+0.50mm	3711	3077	2628	4948	4103	3504

※ The above data is calculated base on Standard Size and Bulk/Nude packing

Panel size	Panel thickness	20'GP Loading Quantity			40'GP Loading Quantity		
	Alu-thickness	3mm	4mm	5mm	3mm	4mm	5mm
1220*2440mm	0.25+0.25mm	2900	2310	1930	5358	4643	3858
1220*2440mm	0.30+0.30mm	2800	2226	1870	5358	4376	3739
1220*2440mm	0.35+0.35mm	2680	2143	1810	5108	4220	3620
1220*2440mm	0.40+0.40mm	2570	2071	1760	4989	4003	3525
1220*2440mm	0.45+0.45mm	2460	2012	1720	4787	3986	3429
1220*2440mm	0.50+0.50mm	2400	1941	1690	4608	3846	3334

※ The above data is calculated base on Standard Size and Wooden Cases packing.

※ The above data is just for reference.

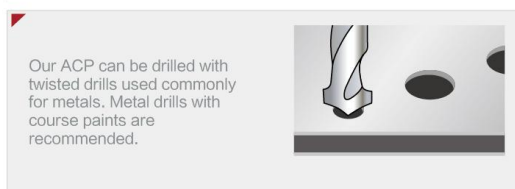
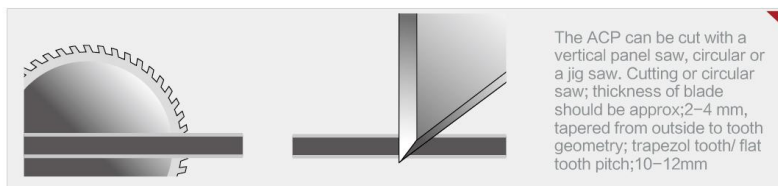

Processing method

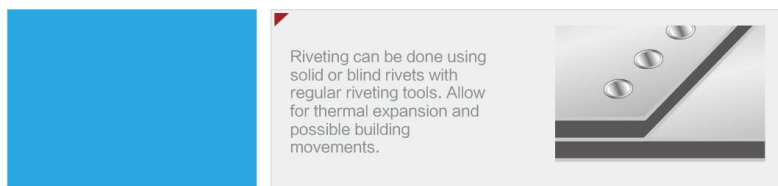
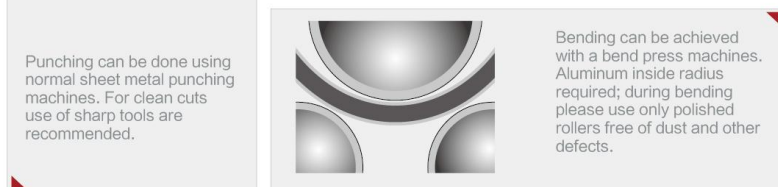
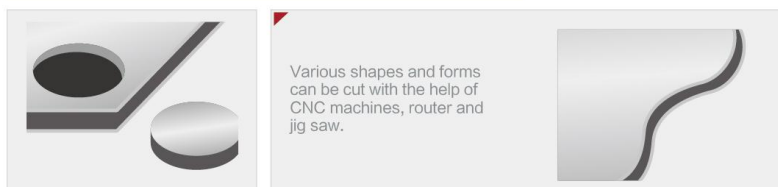

Alcadex ACP can be shaped using a very simple processing method. The technique, called the Routing and Folding method, enables a fabricator to produce various shapes to fit different building designs. A V-shape or rectangular groove is routed on back side of the panel using a grooving machine or a end milling cutter. A thin layer of the core material should be left at the base of the groove. The untouched outer cover sheet can now be bent manually, giving an exact and clean folding line which follows the groove. The outer radius of the folded edge depends on the shape and depth of the groove. Routing can be done using a

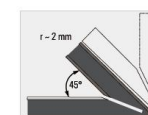
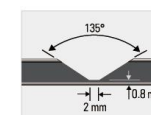
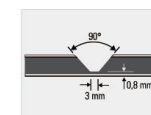

Regular External Wall Installation Method

Wet Sealant Join Method

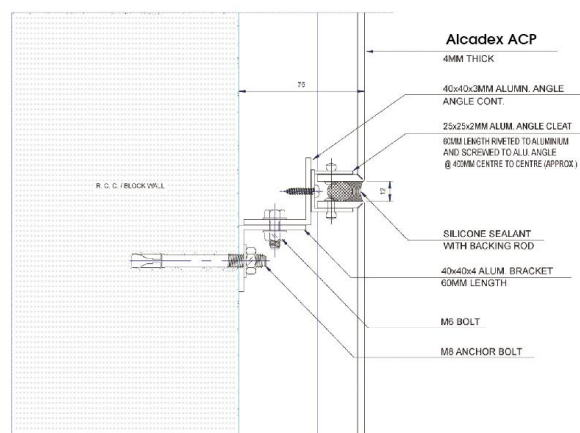
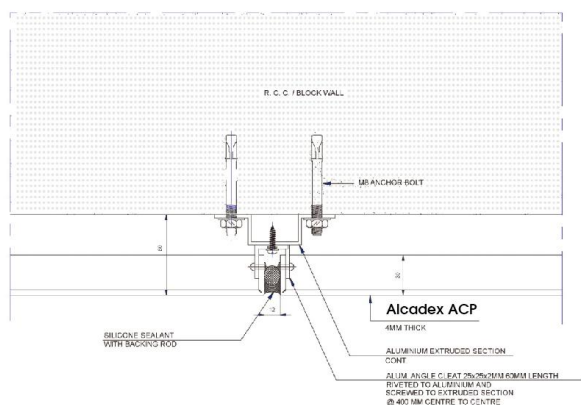

※For further details please refer to Alcadex Installation Guid

Production Process

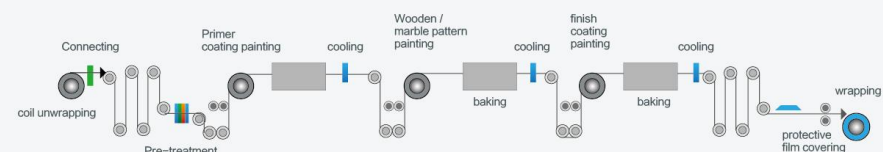

Wooden / Marble Grain Roll Coated Aluminum Coil

Wooden / Marble Grain Aluminum Coil is made with innovative painting technology. Combining traditional roller-painting technology and digital color-printing technique, it is able to print wooden or marble patterns on one-side or both-sides of the aluminum foil. After series of pre-treatment process (eg. Degreasing, cleaning and film-inverting), accurate digital positioning, painting and baking, lifelike wooden/marble patterns will be finished.

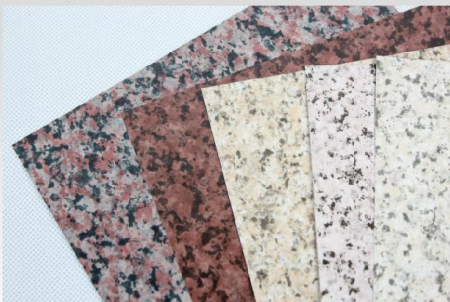

Coating

Wooden / Marble Grain Roll Coating is made with high quality **PE polyester and PVDF fluoro-carbon resin paint supplied by PPG and Beckers**. Under temperature of 224-225°C, the paint is stabilized on the aluminum surface and will not fade even under extreme weather.

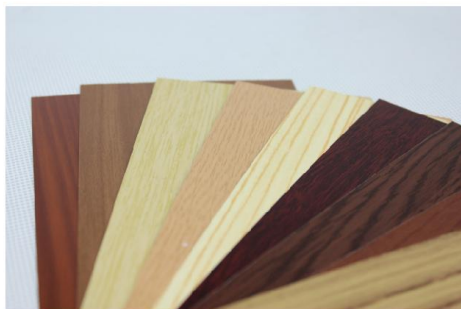

Advantages

Vivid patterns: All patterns are made according to real materials to reach the texture of real wood and marble.

Various choices: More than 100 kinds of lifelike wooden / marble patterns are available for reference. Customized sample pattern making also available.

Durable coating: Self-cleaning, strong weather resistance. Pollution resistant and waterproof. PE polyester coating is valid for 10 years while PVDF fluoro-carbon resin coating is valid for over 15 years.

Compare With Real Wood/ Stone Material

- ◆ Light weight
- ◆ Low cost
- ◆ Easier and convenient to install
- ◆ Environmental friendly and energy saving
- ◆ Anti-dirty and self-cleaning
- ◆ Corrosion resistant and moisture proof
- ◆ Weathering resistance stronger than stone material and valid time longer
- ◆ Excellent ductility, can be made into various shapes



Application

Perfect aluminum surface plate for making aluminum composite panel, aluminum honeycomb panel.
Ceiling, decoration for external and internal wall.
Faceplates for home furniture, domestic apparatus, clapboards, cabinets.
Cleaning plate for hospital, pharmacy factory and packinghouse.

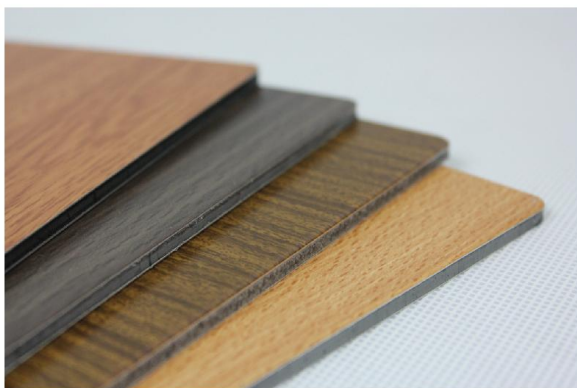

Specification

Application	Aluminum Alloy	Thickness	Width	Weight per roll	Inner diameter	Alloy hardness
Aluminum Composite panel	1100 3003	0.06~0.6mm	1240~1600mm	≤2 tons	405mm 505mm	H18
Aluminum ceiling panel / Aluminum Honeycomb Board	1100 3005 3003 5052	0.3~1.0mm	1000~1350mm	≤2 tons	405mm 505mm	H14 H16 H18



Technical Data

Test Item	Polyester Coating	PVDF Coating
Coating Thickness	≥25 μm	≥25 μm
Gloss Tolerance	≤10° (Gloss<70°) ≤5° (Gloss≥70°)	≤10° (Gloss<70°) ≤5° (Gloss≥70°)
Pencil Hardness	≥HB	≥2H
Coating Flexibility	≤2T	≤2T
Adhesion	≤ Class 1	≤ Class 1
Impact Resistance	50kg · cm No removal of paint nor cracking	50kg · cm No removal of paint nor cracking
Boiling Water Resistance	2 Hours No change	2 Hours No change
Anti-acid capability	2% HCL(Mariatic Acid), 24 Hours, no change	2% HCL(Mariatic Acid), 24 Hours, no change
Anti-alkali capability	2%NaOH(Sodium hydroxide),24 Hours no change	2%NaOH(Sodium hydroxide),24 Hours no change
Butanone Resistance	≥100 times (1kg/cm ²)	≥100 times (1kg/cm ²)
Scour Resistance	≥10,000 times No Change	≥10,000 times No Change

motor city showroom & office tower



Emaar Blvd



Salem Tower



Dubai Health Care



Jumeirah Beach Residences



anantara palm jumeirah & tiara residences



King Abdullah University



Castle House



Project

Project Al Bassam Tower



Dubai Maritime City - Labour Accomodation



Dubai Marina



Project List

S.No	Project name	Location	Consultants	Contractor	Aluminium contractor	Approx. Qty M2
1	B+G+6 Hotel Building Plot No.A002-028	Dubai	DAR Consultants	AL TAAMIR Gen. Contg.	Alumetal LLC	5,000
2	DIFC Gate Village	Dubai	Hopkins Architect	Arabtec Construction LLC	Multiforms LLC	50,000
3	G+M+1 Showroom	Dubai	ARCHON	AL Bwardy Engineering Ent.	Alumetal LLC	5,000
4	Golf tower-2	Dubai	National Engr. Bureau	Al Basti & Mukha LLC	Multiforms LLC	20,000
5	The Avenues Kuwait	Kuwait	Nor Group Cons. Ltd.	Alghanim Int'l Gen. Trad.	MERO-TSK GmbH	10,000
6	Residential Bldg.G+10+PH	Sharjah	Emirates Engineering	Al Whasba Contracting	Alumetal LLC	10,000
7	Al Dafna Residential Tower	Qatar	Architectural & Engr. Con.	MZ & Partners	Valley of the Kings	40,000
8	Al Dafna Residential Tower	Qatar	Architectural & Engr. Con.	MZ & Partners	Egyptian Belgian Co.	40,000
9	Ajman Building	Ajman	Fauzi Orabi	New Vision Contracting	Alumetal LLC	4,000
10	Burj View Plot-5	Dubai	Nor Group Cons. Ltd.	Bin Laden Contracting	Multiforms LLC	16,000
11	Wafi Hotel & Mall Phase 5 Extension	Dubai	Arrif & Bintok	Khanshab Civil Engineering	Alumetal LLC	5,000
12	Movenpick Hotel & Spa & Oceana Residences	Dubai	Dar Al-Handasah	Dar Al-Handasah	Multiforms LLC	55,000
13	Ajman Expo	Ajman	Fauzi Orabi	New Vision Contracting	Alumetal LLC	10,000
14	Uniworld Headquarters Building	Jebel Ali	Kalavaal Architects	Penta Contracting Co.	Alumetal LLC	7,000
15	The Index Bldg. Project, DIFC	Dubai	Foster & Partners/Woods	Nasa Multiplex	Multiforms LLC	35,000
16	Contructions of Zayed University	Media City	Dewan Al Emara	Engineering Contracting Co.	Alumetal LLC	7,000
17	City Hospital @ Plot no. B/P-37 @ Dubai	Dubai	SHARAFI-PHB	AL Ahmadih Aktor	Alumetal LLC	5,000
18	Dubai Maritime City	Dubai	ARENCO	Arabtec Construction LLC	Alumetal LLC	3,756
19	2B+G+14 Comm'l & Resi.Bldg.@ Emirates Hill	Dubai	DUBARCH	Bin Belalla Contracting LLC	Alumetal LLC	10,000
20	Abu Ghazali Towers	Sharjah	Al Emmar Engineering	Darwish Engineering Emirates	Alumetal LLC	13,916
21	S-20603 Jafza	Dubai	Green Line International	Core Construction Company	Alumetal LLC	11,143
22	S-20603 Jafza	Dubai	Green Line International	Core Construction Company	Alumetal LLC	5,000
23	Al Habtour Plaza, Dubai Festival City	Dubai	Al Futaim Carillion	Al Burj Engineering & Cons.	Multiforms LLC	7,000
24	Albwardy Club House @ Awir Polo	Dubai	ARCHON	Albwardy Engineering LLC	Alumetal LLC	2,000

S.No	Project name	Location	Consultants	Contractor	Aluminium contractor	Approx. Qty M2
25	IBIS & Movetel Hotels @ Port Saeed, Dubai	Dubai	ATKINS	Khanshab Civil Engineering	Alumetal LLC	2,423
26	Motor City-automall	Dubai	Burt, Hill	Nasa Multiplex	Multiforms LLC	45,000
27	IBIS & Suit Hotels @ Al Barsha, Dubai	Dubai	Khatib & Alami Cons. Engr.	Khanshab Civil Engineering	Alumetal LLC	4,609
28	Dubai Marina Mall (NS01)	Dubai	DP Architects PTE LTD	Al Jaber Engr. & Cont. (ALEC)	Multiforms LLC	22,000
29	Hotel JAL Tower Dubai 1B+G+1M+49 Floor+4Mech+	Dubai	Dimension Consultant Architect	Aerated Concrete Industries	(ALICO) Alum.	60,000
30	IBIS Hotel	Dubai		Dutco Balfour Beatty LLC	Multiforms LLC	12,000
31	Dubai Marina Mall Louvers (DS04)	Beirut	Khatib & Alami Cons. Engr.	Al Jaber Engr. & Cont. (ALEC)	Multiforms LLC	10,000
32	WATERFALLS MALL	Dubai	DP Architects PTE LTD	Al-Ahlia Contracting Group	Alco Kuwait	7,000
33	Emaar Boulevard Plaza Burj Dubai Plot 12&13	Dubai	Nezar Al Anjari Consulting B.	Samsung Baytur Corporation	Multiforms LLC	14,000
34	The Lofts-Burj Dubai Development	Dubai	AEDAS (Rep. Office)	Al Futaim Carillion	Multiforms LLC	8,000
35	Castle House-London Project	UK	Noor Group Cons. Ltd	Multiplex Development (UK) LTD	Multiforms LLC	15,000
36	King Abdullah University of Science & Technology	KSA	WSP Group	Saudi Oger LTD.	Multiforms LLC	52,000
37	Dubai Maritime City(Labour Accom. Complex)	Dubai	Oger International/ Hok	Pauling Middle East Co. LLC	Multiforms LLC	12,000
38	Dubai Health Care City Hotel	Dubai	Arence	Al-Basti & Muktha LLC	Multiforms LLC	15,000
39	Renaissance Hotel @ Motor City	Dubai	Robert Matthew, Johnson	Nasa Multiplex	Multiforms LLC	18,000
40	Nad Al Shiba Race Course	Dubai	Burt, Hill	Arabtec Construction LLC	Multiforms LLC	30,000
41	Salam Plaza	Doha Qatar	Teo A. khing Design Cons.	Alunasa WLL	Alunasa W.L.L.	10,000
42	Navigation Tower	Doha Qatar	Salam studio & Store	Hill Int'l Limited Co.	Alunasa W.L.L.	6,000
43	Cayan Building	Doha Qatar	MAZ & Partners & Saz Const.	Test contracting Co.	Wall technology	7,000
44	MAF Hospitality Tower	Dubai	Schuster Pechtold	Khansaheb	Multiforms LLC	6,000
45	3 TOWERS (X1,X2,X3, towers)	Dubai	NEB	Belhasa Cont.	AL FAYHA ALUMINIUM	21,006
46	2037 TIARA RESIDENCES	Dubai		Arabtec Construction LLC	Multiforms LLC	5,000
47	2020 INDEX TOWER	Dubai	Norman Foster & Patners	Multiplex	Multiforms LLC	30,000
48	TORCH TOWER 80th FLOOR	Dubai	National engr. Bureau	Dubai Civil Engineering	Al Hamad Construction	40,000

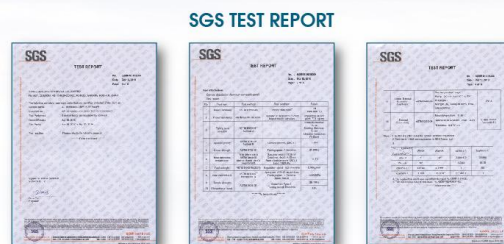
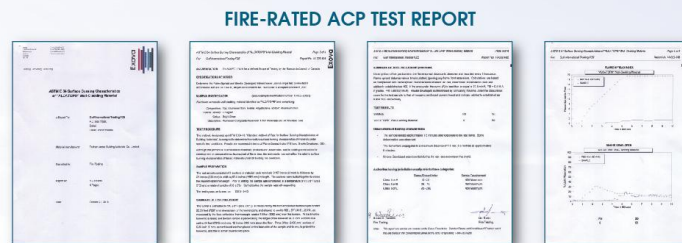

Test report & Certificates

